

Attachment 12

Additional Arborist advice

Lawrence and Co.

Helena Miller

From: Matthew Laurence <matthew@laurenceco.com.au>
Sent: Thursday, 22 September 2022 10:30 AM
To: Peter Jones
Subject: L&Co2021021_Eastern Quarter St Leonards: Trees within 5m of the boundary
Attachments: L&Co2021021_TLP within 5m.jpg; Plates.png

Follow Up Flag: Follow up
Flag Status: Completed

Dear Peter,

This email is to provide details of our site visit conducted on 27.8.22 to assess additional trees within 5m of the northern site boundary. The trees were observed as part of an extension of the existing survey and their location is in the attached Tree Location Plan (Trees 132 & 133). Tree 133 was a street tree and outside of the 5m setback (approximately 6m). Tree group 132 were identified as *Pittosporum tenuifolium* (Kohuhu) and formed a hedge from the northern boundary. However, the trees within 5m were already dead at the time of the survey (see attached Plates). The remaining trees are outside of the 5m set back and given their small Tree Protection Zones are unlikely to be directly affected by the proposal. The tree VTA data is provided in the table below:

Tree No.	Location	Species	Height	DBH comb. (mm)	
132	_OS	Pittosporum tenuifolium (Kohuhu)		75	Set ba
133	_OS	Lophostemon confertus (Brush Box)		550	

Please let me know if you require any further information.

Kind Regards,
Dr Matthew Laurence
Director
BSc(Hons), PhD(Plant Pathology), GradCert(Arbiculture)
Institute of Australian Consulting Arboriculturists -Accredited Member (ACM0502016)
Australasian Plant Pathology Journal-Senior Editor
Australasian Plant Pathology Society-Member
ResearchGate Profile - https://www.researchgate.net/profile/Matthew_Laurence



mob: 0404 28 28 25
address: PO Box 2169, Clovelly, NSW, 2031
website: <https://www.laurenceco.com.au/>
abn: 61 625 300 530



This email is intended for the addressee(s) named and may contain confidential and/or privileged information. If you are not the intended recipient, please notify the sender and then delete it immediately. Any views expressed in this email are those of the individual sender except where the sender expressly and with authority states them to be the views of Laurence & Co Consultancy.

PLEASE CONSIDER THE ENVIRONMENT BEFORE PRINTING THIS EMAIL

Tree Location Plan: Trees within 5m north site boundary

L&Co Legend

- 5m set back
- Tree dead
- Tree retained

Tree Group 132

133

ADJOINS SHEET 3

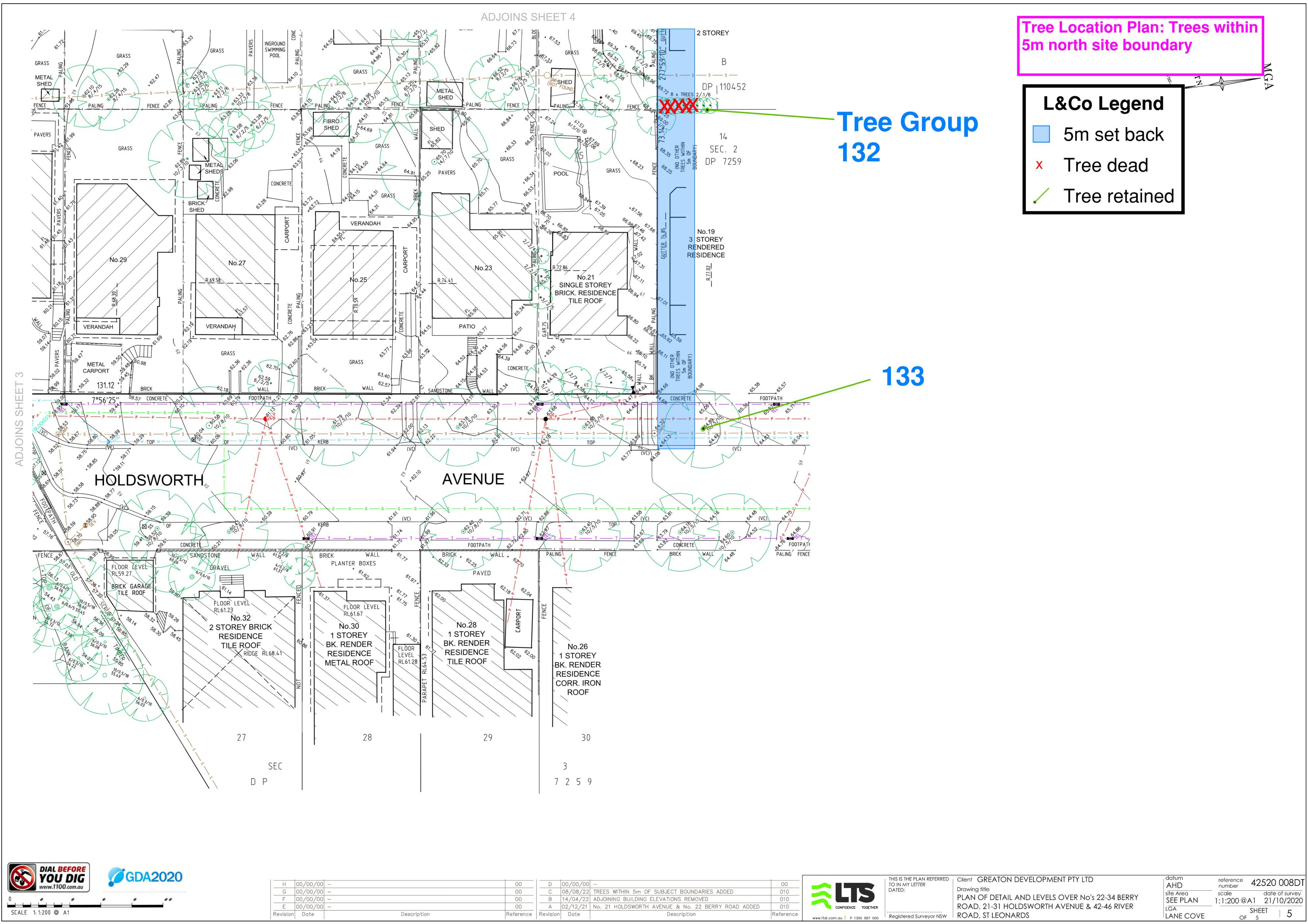

SCALE 1:1200 @ A1

H	00/00/00	—	00	D	00/00/00	—	00
G	00/00/00	—	00	C	08/08/22	TREES WITHIN 5m OF SUBJECT BOUNDARIES ADDED	010
F	00/00/00	—	00	B	14/04/22	ADJOINING BUILDING ELEVATIONS REMOVED	010
E	00/00/00	—	00	A	02/12/21	No. 21 HOLDSWORTH AVENUE & No. 22 BERRY ROAD ADDED	010
Revision	Date	Description	Reference	Revision	Date	Description	Reference



THIS IS THE PLAN REFERRED TO IN MY LETTER DATED:

Client GREATON DEVELOPMENT PTY LTD
Drawing title
PLAN OF DETAIL AND LEVELS OVER No's 22-34 BERRY ROAD, 21-31 HOLDSWORTH AVENUE & 42-46 RIVER ROAD, ST LEONARDS

datum AHD
reference number 42520 008DT
site Area
scale 1:1200 @ A1
date of survey 21/10/2020
LGA LANE COVE
SHEET 5 OF 5

